



# CROWTHORNE

LUXURY APARTMENTS



# CROWTHORNE

## LUXURY APARTMENTS



It doesn't matter if you are a goal-driven businessperson or a family-orientated couple with children; your motivation to live in this upmarket apartment development will remain the same. **Privacy, space and security.** The entire estate with its facilities have been designed to offer residents a premium quality of life with facilities ranging from tennis, soccer, outdoor gym and a large swimming pool. Unit layouts are generally spacious and easy to furnish with opulent fittings and finishes. Security is of the utmost importance and great care was taken to ensure residents and their families are safe without security being intrusive.

Access to the estate is restricted to a single **secure gate-house** which is manned 24 hours a day. Access will only be granted to residents and their approved guests.

Units come in a variety of **different designs**. Layouts range from spacious one, two and three bedroom options.

A well-appointed **clubhouse** consisting of a lounge and café-style tables overlooks a large outdoor swimming pool, braai facilities and tennis court with pavilion. There is also a laundromat for the exclusive use of residents.

Numerous **children's playparks** are incorporated into the indigenous landscaping with walking trails along the way. Outdoor gym equipment can be found on this route.

Crowthorne Luxury Apartments offer residents a myriad of **free benefits** such as access to internet, tennis coaching, hip-hop dancing classes, indoor gym with free weekly group classes, outdoor gym equipment along a trim-track/walking trail, mini soccer field, kids' play parks, clubhouse, pool, etc.

### Crowthorne Luxury Apartments: Welcome to the Neighbourhood

- 0 km Bentley Preparatory School (0.1km).
- 1 km Summerhill School (1.38km), SPARK Carlswald (1.4km), Earlybird Educare Carlswald (1.4km), Crowthorne Shopping Centre (1.6km).
- 2 km San Ridge Square Shopping Centre (2.2km), Kyalami Corner Shopping Centre (2.4km), Reddford House Blue Hills (2.8km).
- 3 km Blue Hills Mall (3.5km), New Road / N1 Intersection (3.1km).
- 4 km Waterfall Netcare Hospital (4.5km), Mall of Africa (4.6km).
- 5 km Midrand Gautrain Station (4.7km).



Please Note: All distances were measured as the crow flies. There are many different routes to each item.

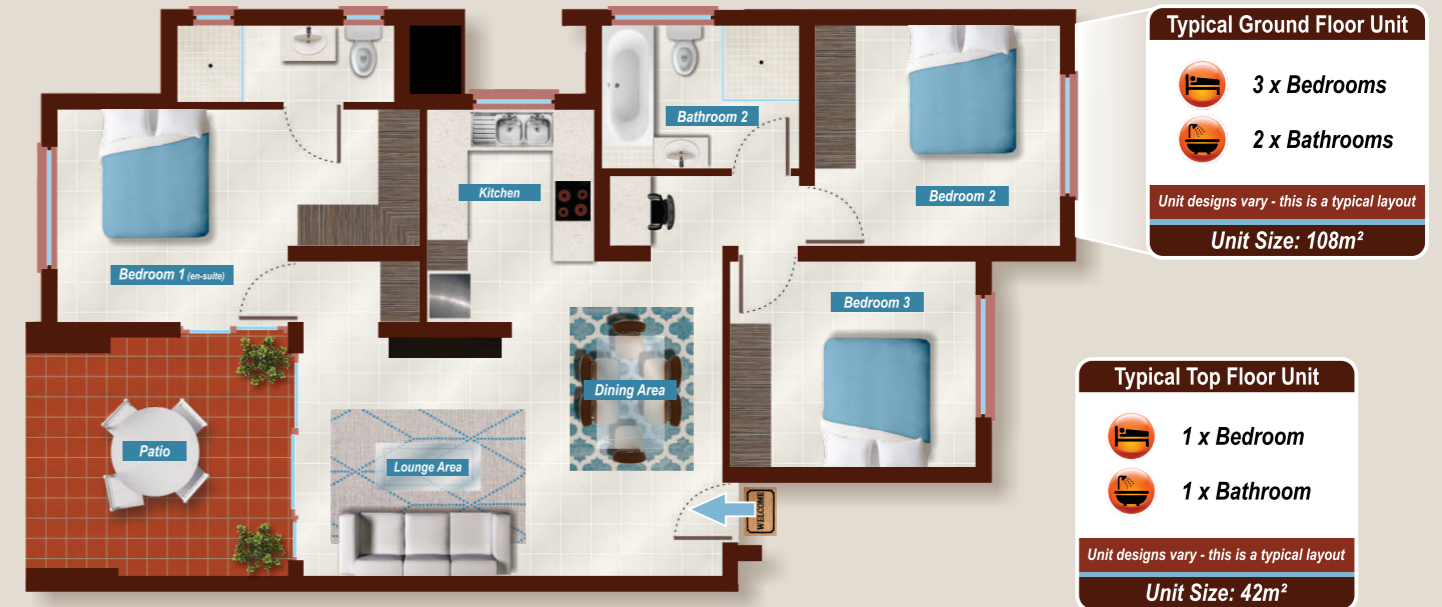

“Unit layouts are generally spacious and easy to furnish with opulent fittings and finishes.”

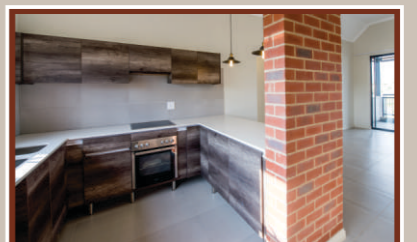

Please Note: Unit layouts may be mirrored according to their position within the building. Please ensure you have visited the actual unit before signing the lease agreement.

# CROWTHORNE

## LUXURY APARTMENTS



### Crowthorne Luxury Apartments: Welcome to the Neighbourhood

0 km	Bentley Preparatory School (0.1km)
1 km	Summerhill School (1.38km), SPARK Carlswald (1.4km), Earlybird Educare Carlswald (1.4km), Crowthorne Shopping Centre (1.6km)
2 km	San Ridge Square Shopping Centre (2.2km), Kyalami Corner Shopping Centre (2.4km), Reddford House Blue Hills (2.8km)
3 km	Blue Hills Mall (3.5km), New Road / N1 Intersection (3.1km)
4 km	Waterfall Netcare Hospital (4.5km), Mall of Africa (4.6km), Midrand Gautrain Station (4.7km)
5 km	

Please Note: All distances were measured as the crow flies. There are many different routes to each item.

It doesn't matter if you are a goal-driven businessperson or a family-orientated couple with children; your motivation to live in this upmarket apartment development will remain the same. **Privacy, space and security.** The entire estate with its facilities have been designed to offer residents a premium quality of life with facilities ranging from tennis, soccer, outdoor gym and a large swimming pool. Unit layouts are generally spacious and easy to furnish with opulent fittings and finishes. Security is of the utmost importance and great care was taken to ensure residents and their families are safe without security being intrusive.

Access to the estate is restricted to a single **secure gatehouse** which is manned 24 hours a day. Access will only be granted to residents and their approved guests.

Units come in a variety of **different designs**. Layouts range from spacious one, two and three bedroom options.

A well-appointed **clubhouse** consisting of a lounge and café-style tables overlooks a large outdoor swimming pool, braai facilities and tennis court with pavilion. There is also a laundromat for the exclusive use of residents.

Numerous **children's playparks** are incorporated into the indigenous landscaping with walking trails along the way. Outdoor gym equipment can be found on this route.

Crowthorne Luxury Apartments offer residents a myriad of **free benefits** such as access to internet, tennis coaching, hip-hop dancing classes, indoor gym with free weekly group classes, outdoor gym equipment along a trim-track/walking trail, mini soccer field, kids' play parks, clubhouse, pool, etc.

- Gatehouse
- Kids' Play Areas
- Walking Trail
- Clubhouse
- Mini Soccer Field
- Tennis Court
- Swimming Pool
- Indoor Gym
- Braai Area
- Outdoor Movie Screen
- Laundromat
- Outdoor Gym



### Just some of the reasons to LIVE at Crowthorne Luxury Apartments:

<b>FREE Internet Access</b>	<b>Soccer Coaching</b>	<b>FREE Outdoor Movies</b>	<b>FREE Special Events</b>
<b>FREE Group Gym Classes</b>	<b>FREE Tennis Coaching</b>	<b>FREE Bootcamp Sessions</b>	<b>FREE Hip-Hop Dancing</b>

<b>24-hour Security</b>	<b>Kids' Play Areas</b>	<b>Outdoor Gym</b>
<b>Spacious Interiors</b>	<b>Swimming Pool</b>	<b>Clubhouse</b>



“Unit layouts are generally spacious and easy to furnish with opulent fittings and finishes.”

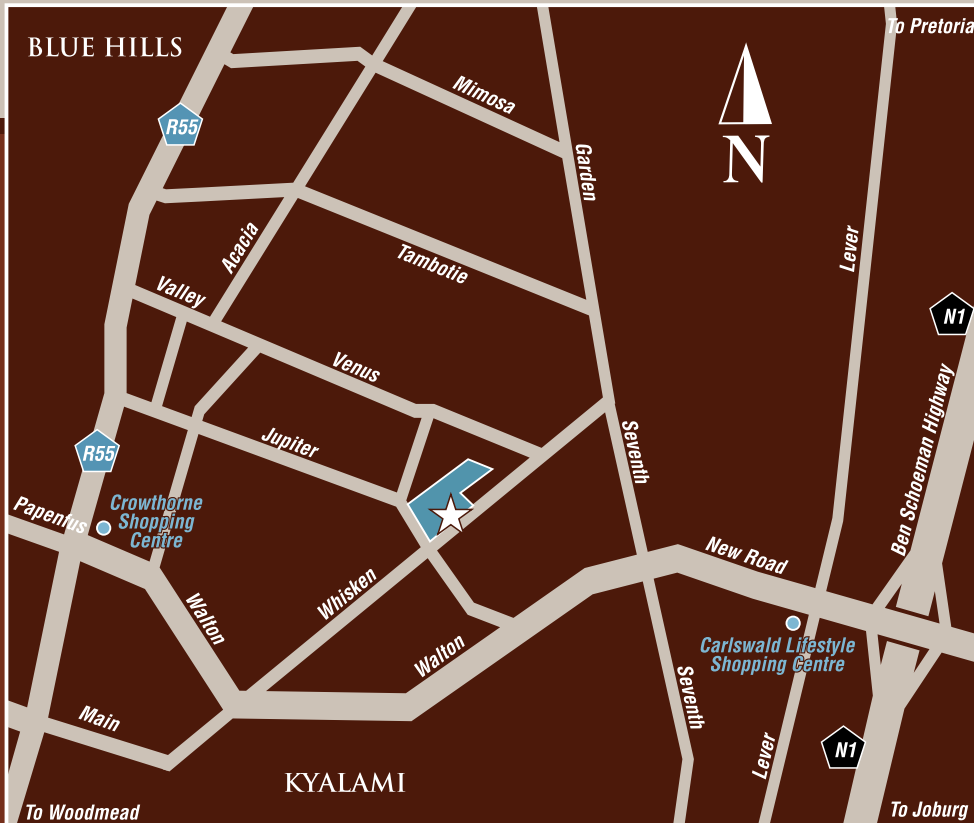

For more information, please visit  
[www.houss.co.za](http://www.houss.co.za)

Rental office hours:  
 09h00-17h00, 7 days a week

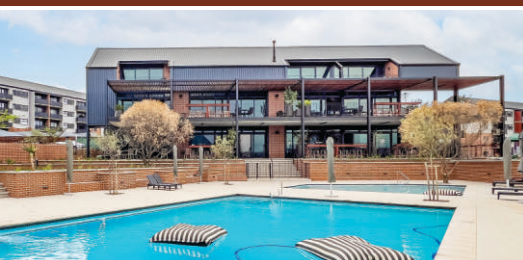

**Indawo Lifestyle Apartments**  
 Waterfall, Mushroom Rd.



**Ndlovu Lifestyle Apartments**  
 Midrand, Olifantsfontein Rd.



**Bahari Lifestyle Apartments**  
 Cape Town, Somerset West, Copacabana Blvd.



**The Parks Lifestyle Apartments**  
 Riversands, Century Blvd.



**5ive on Thirteenth Lifestyle Apartments**  
 Northcliff/Fairlands, 13th Ave.



**The Villas, Waterfall**  
 Waterfall Estates, Barbet Cres.

For more information on any of these developments, contact us on [011 300 8702](tel:0113008702)